

FIRE-RATED JOINT THROUGH CONCRETE WALL OR BLOCK WALL ASSEMBLY

ASSEMBLY RATING = 2-HR.

CLASS II MOVEMENT CAPABILITIES - 12.5% COMPRESSION OR EXTENSION

L-RATING AT AMBIENT = LESS THAN 1 CFM / LIN FT

L-RATING AT 400°F = LESS THAN 1 CFM / LIN FT

WWD0270a.051721

TOP VIEW

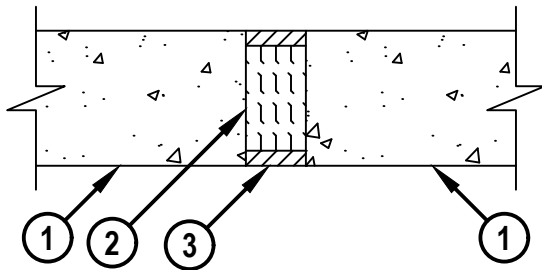

CONFIGURATION A

TOP VIEW

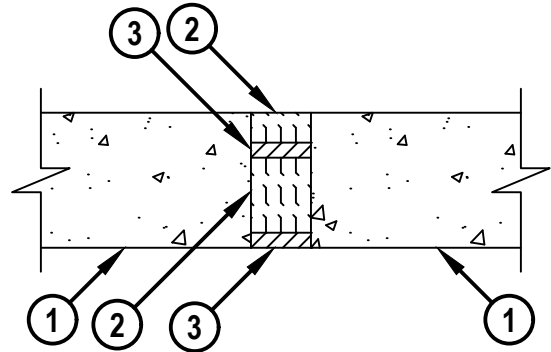

CONFIGURATION B

1. CONCRETE WALL ASSEMBLY (2-HR. FIRE-RATING) :
 - A. LIGHTWEIGHT OR NORMAL WEIGHT CONCRETE WALL (MINIMUM 4-1/2" THICK).
 - B. ANY UL/cUL CLASSIFIED CONCRETE BLOCK WALL.
2. MINERAL WOOL SAFING (MIN. 4 PCF DENSITY) COMPRESSED 50% (SEE TABLE BELOW). FOR CONFIGURATION B, INSTALL MINIMUM 1" THICKNESS MINERAL WOOL FLUSH WITH INACCESSIBLE SIDE OF WALL.
3. HILTI CP 606 FLEXIBLE FIRESTOP SEALANT (SEE TABLE BELOW).

MAX JOINT WIDTH	MIN THICKNESS OF MINERAL WOOL INSTALLED BETWEEN LAYERS OF SEALANT	MIN DEPTH HILTI CP 606
2"	2"	1/2"
1"	2-1/2"	1/4"



HILTI, Inc.
Plano, Texas USA (800) 879-8000

Sheet 1 of 1
Scale 5/32" = 1"
Date May 17, 2021

Drawing No.
**WWD
0270a**