

| METAL PIPE | |
|---------------------------------|-----------|
| TYPE | MAX. DIA. |
| STEEL PIPE (SCH. 10 OR HEAVIER) | 30" |
| CAST IRON PIPE | 30" |
| COPPER PIPE | 6" |
| STEEL CONDUIT | 6" |
| EMT | 4" |

1 METAL PIPE THROUGH CONCRETE OVER METAL DECKING (2-HR.)
M.3.1 NOT TO SCALE

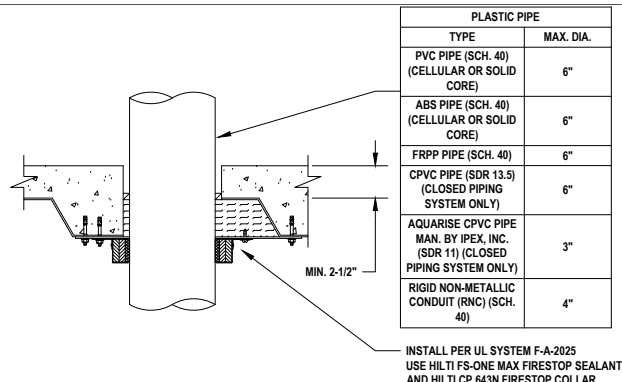

| PLASTIC PIPE | |
|--|-----------|
| TYPE | MAX. DIA. |
| PVC PIPE (SCH. 40) (CELLULAR OR SOLID CORE) | 6" |
| ABS PIPE (SCH. 40) (CELLULAR OR SOLID CORE) | 6" |
| FRPP PIPE (SCH. 40) | 6" |
| CPVC PIPE (SDR 13.5) (CLOSED PIPING SYSTEM ONLY) | 6" |
| AQUARISE CPVC PIPE MAN. BY IPEX, INC. (SDR 11) (CLOSED PIPING SYSTEM ONLY) | 3" |
| RIGID NON-METALLIC CONDUIT (RNC) (SCH. 40) | 4" |

2 PLASTIC PIPE THROUGH CONCRETE OVER METAL DECKING (2-HR.)
M.3.1 NOT TO SCALE

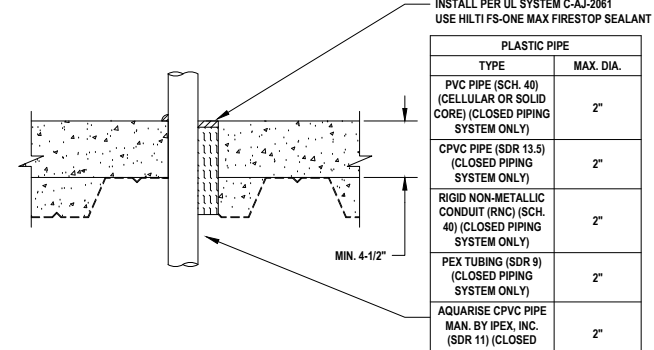

| PLASTIC PIPE | |
|--|-----------|
| TYPE | MAX. DIA. |
| PVC PIPE (SCH. 40) (CELLULAR OR SOLID CORE) (CLOSED PIPING SYSTEM ONLY) | 2" |
| CPVC PIPE (SDR 13.5) (CLOSED PIPING SYSTEM ONLY) | 2" |
| RIGID NON-METALLIC CONDUIT (RNC) (SCH. 40) (CLOSED PIPING SYSTEM ONLY) | 2" |
| PEX TUBING (SDR 9) (CLOSED PIPING SYSTEM ONLY) | 2" |
| AQUARISE CPVC PIPE MAN. BY IPEX, INC. (SDR 11) (CLOSED PIPING SYSTEM ONLY) | 2" |

3 PLASTIC PIPE THROUGH CONCRETE OVER METAL DECKING (2-HR.)
M.3.1 NOT TO SCALE

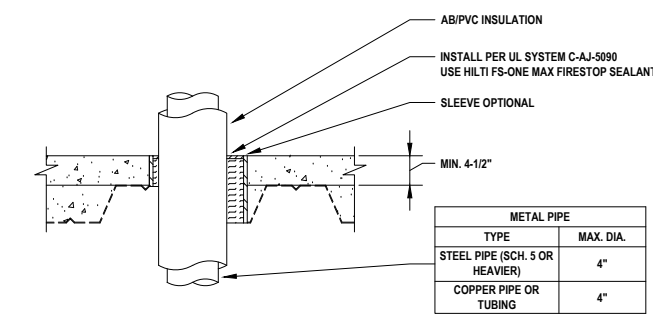

| METAL PIPE | |
|--------------------------------|-----------|
| TYPE | MAX. DIA. |
| STEEL PIPE (SCH. 5 OR HEAVIER) | 4" |
| COPPER PIPE OR TUBING | 4" |

4 METAL PIPE WITH AB/PVC INSULATION THROUGH CONCRETE OVER METAL DECKING (2-HR.)
M.3.1 NOT TO SCALE

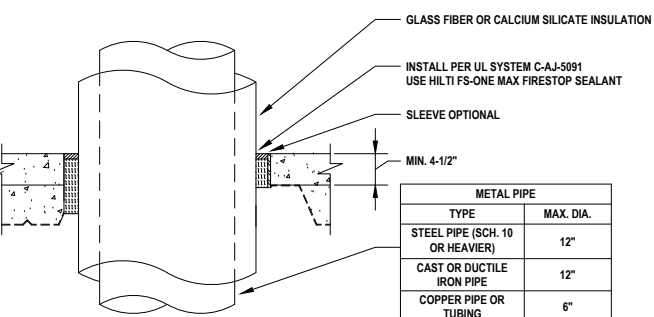

| METAL PIPE | |
|---------------------------------|-----------|
| TYPE | MAX. DIA. |
| STEEL PIPE (SCH. 10 OR HEAVIER) | 12" |
| CAST OR DUCTILE IRON PIPE | 12" |
| COPPER PIPE OR TUBING | 6" |

5 METAL PIPE WITH GLASS FIBER OR CALCIUM SILICATE INSULATION THROUGH CONCRETE OVER METAL DECKING (2-HR.)
M.3.1 NOT TO SCALE

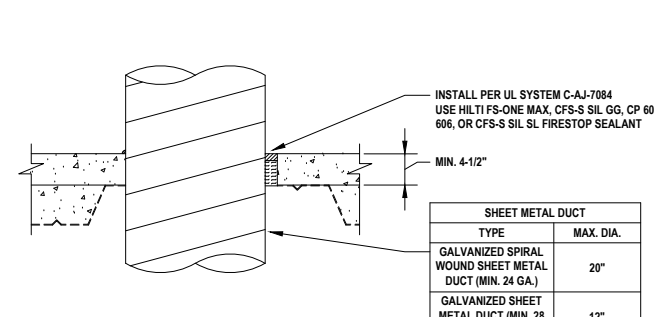

| SHEET METAL DUCT | |
|--|-----------|
| TYPE | MAX. DIA. |
| GALVANIZED SPIRAL WOUND SHEET METAL DUCT (MIN. 24 GA.) | 20" |
| GALVANIZED SHEET METAL DUCT (MIN. 28 GA.) | 12" |

6 ROUND SHEET METAL DUCT THROUGH CONCRETE OVER METAL DECKING (2-HR.)
M.3.1 NOT TO SCALE

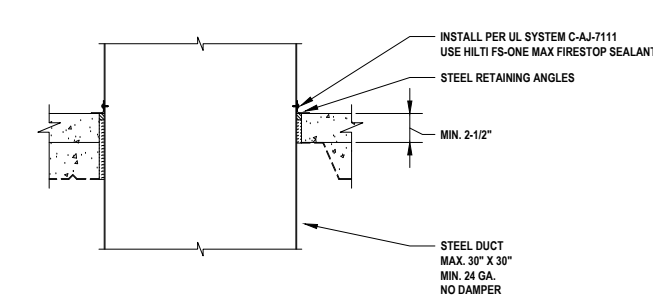

STEEL DUCT
MAX. 30" X 30"
MIN. 24 GA.
NO DAMPER

7 METAL DUCT (WITHOUT DAMPER) THROUGH CONCRETE OVER METAL DECKING (2-HR.)
M.3.1 NOT TO SCALE

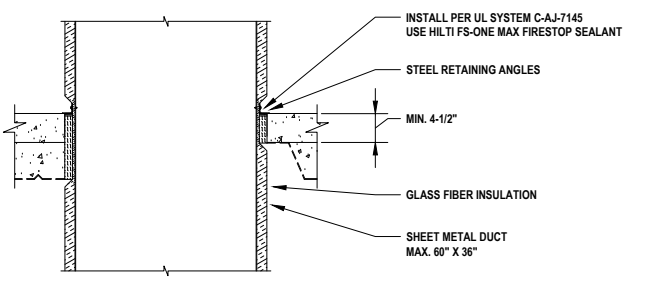

SHEET METAL DUCT
MAX. 60" X 36"

8 SHEET METAL DUCT WITH GLASS FIBER INSULATION THROUGH CONCRETE OVER METAL DECKING (2-HR.)
M.3.1 NOT TO SCALE

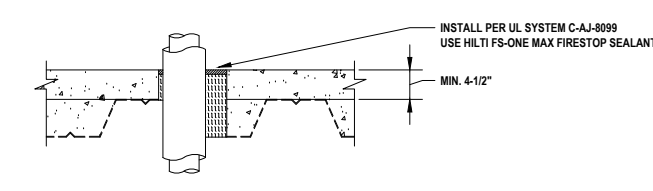

INSTALL PER UL SYSTEM C-AJ-8099
USE HILTI FS-ONE MAX FIRESTOP SEALANT

9 MULTIPLE PENETRATIONS THROUGH CONCRETE OVER METAL DECKING (2-HR.)
M.3.1 NOT TO SCALE

Notes:

- Refer to the following specifications for firestopping.
 - 07 84 00 Firestopping
 - 07 84 13 Penetration Firestopping
 - 22 00 00 Plumbing
 - 23 00 00 HVAC
 - 26 00 00 Electrical
 - 27 06 37 Communication
- For Quality Control requirements, refer to the Quality Control portion of the specification.
- Details shown are typical details, containing general information only. Always refer to the full UL system detail for complete system requirements. If field conditions do not match requirements of details, approved alternate details shall be utilized. Design requirements, field conditions and dimensions need to be verified for compliance with the details, including but not limited to the following:
 - * Fire Rating (F-Rating)
 - * Temperature Rating (T-Rating)
 - * Leakage Rating (L-Rating)
 - * Water Rating (W-Rating)
 - * Annular Space
 - * Percent Fill
 - * Movement
 - * Type and thickness of fire-rated construction.
- If alternate details matching the field conditions are not available, manufacturer's engineering judgment drawings are acceptable. Contact Hilti Inc. for alternative systems or Engineering Judgment (800-879-8000) Drawings shall follow the International Firestop Council (IFC) Guidelines for Evaluating Firestop Systems Engineering Judgments.
- References:
 - * 2013 Underwriter's Laboratories Fire Resistance Directory, Volumes 1 & 2
 - * NFPA 101 Life Safety Code
 - * NFPA 70 - National Electric Code
 - * All governing local and regional building codes
- Firestop System installation must meet requirements of ASTM E-814 (UL 1479) tested assemblies that provide a fire rating equal to that of construction being penetrated.
- All rated through-penetration assemblies shall be prominently labeled with a Hilti Firestop Label equipped with a QR code with the following information:
 - * Warning! - Do Not Disturb
 - * Through Penetration Firestop System
 - * UL System # * Product(s) used
 - * Hourly Rating (F-Rating)
 - * Installation Date
 - * Contractor's Name
- For outlet boxes requiring protection, use only Wall Opening Protective Materials, category CLIV as classified by Underwriter's Laboratories, Fire Resistance Directory (Volume 1.)

<Notes to designer (delete this note after reading and replace with title block information)>
 1. Any modification to these details could result in an application/system not meeting the UL or Intertek Classification or the intended temperature or fire ratings.
 2. Details shown are up to date as of February 2015.
 3. For additional information on the details, refer to the most current "Underwriter's Laboratories Fire Resistance Directory (volume 2.)"

JOB NUMBER: _____

DRAWN: _____

CHECKED: _____

ISSUE DATE: _____

REVISIONS: _____

CONTENTS: _____

MECHANICAL PENETRATIONS
CONCRETE OVER METAL DECK
2 HR.

SHEET NAME: _____

M.3.1

SHEET NUMBER: _____

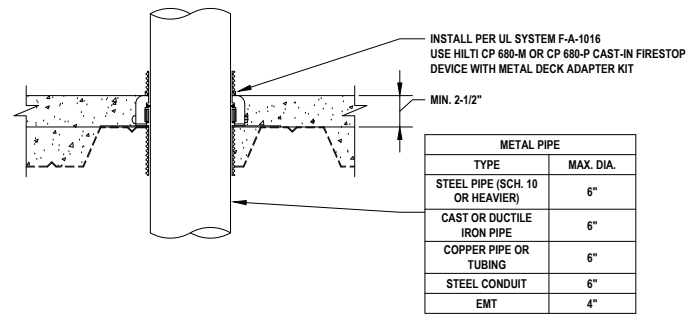

1
M.3.2 METAL PIPE THROUGH CONCRETE OVER METAL DECKING (2-HR.)
NOT TO SCALE

| METAL PIPE | |
|---------------------------------|-----------|
| TYPE | MAX. DIA. |
| STEEL PIPE (SCH. 10 OR HEAVIER) | 6" |
| CAST OR DUCTILE IRON PIPE | 6" |
| COPPER PIPE OR TUBING | 6" |
| STEEL CONDUIT | 6" |
| EMT | 4" |

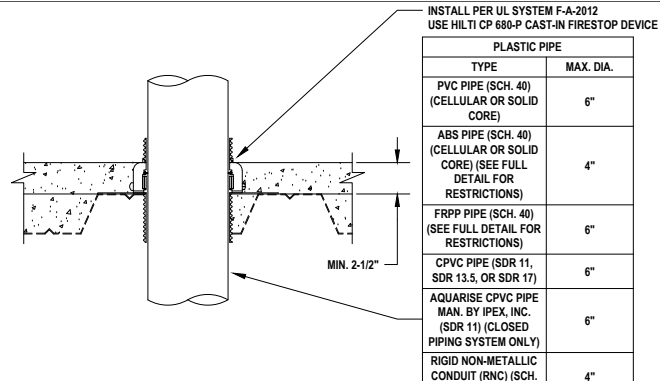

2
M.3.2 PLASTIC PIPE THROUGH CONCRETE OVER METAL DECKING (2-HR.)
NOT TO SCALE

| PLASTIC PIPE | |
|--|-----------|
| TYPE | MAX. DIA. |
| PVC PIPE (SCH. 40) (CELLULAR OR SOLID CORE) | 6" |
| ABS PIPE (SCH. 40) (CELLULAR OR SOLID CORE) (SEE FULL DETAIL FOR RESTRICTIONS) | 4" |
| FRPP PIPE (SCH. 40) (SEE FULL DETAIL FOR RESTRICTIONS) | 6" |
| CPVC PIPE (SDR 11, SDR 13.5, OR SDR 17) | 6" |
| AQUARISE CPVC PIPE MAN. BY IPEX, INC. (SDR 11) (CLOSED PIPING SYSTEM ONLY) | 6" |
| RIGID NON-METALLIC CONDUIT (RNC) (SCH. 40) | 4" |
| SYSTEM 15 PVC PIPE MAN. BY IPEX, INC. (CELLULAR OR SOLID CORE) | 6" |

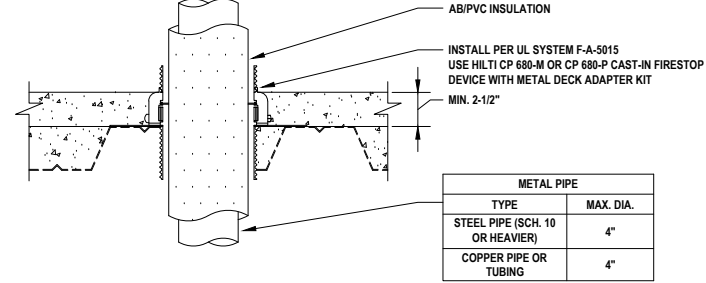

3
M.3.2 METAL PIPE WITH AB/PVC INSULATION THROUGH CONCRETE OVER METAL DECKING (2-HR.)
NOT TO SCALE

| METAL PIPE | |
|---------------------------------|-----------|
| TYPE | MAX. DIA. |
| STEEL PIPE (SCH. 10 OR HEAVIER) | 4" |
| COPPER PIPE OR TUBING | 4" |

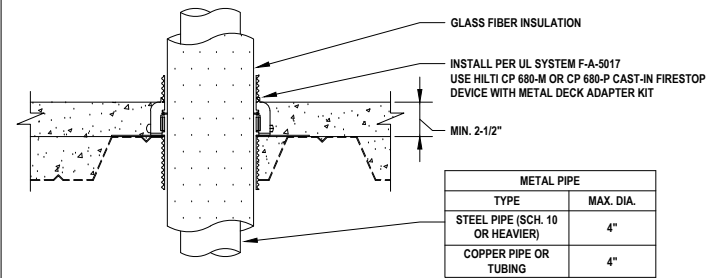

4
M.3.2 METAL PIPE WITH GLASS FIBER INSULATION THROUGH CONCRETE OVER METAL DECKING (2-HR.)
NOT TO SCALE

| METAL PIPE | |
|---------------------------------|-----------|
| TYPE | MAX. DIA. |
| STEEL PIPE (SCH. 10 OR HEAVIER) | 4" |
| COPPER PIPE OR TUBING | 4" |

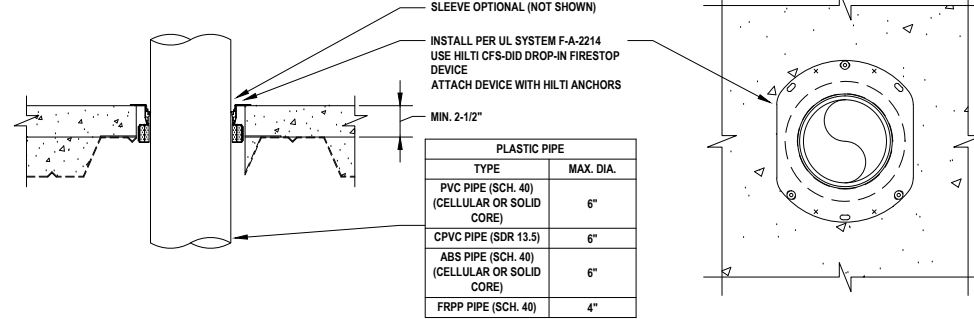

5
M.3.2 PLASTIC PIPE THROUGH CONCRETE OVER METAL DECKING (2-HR.)
NOT TO SCALE

| PLASTIC PIPE | |
|---|-----------|
| TYPE | MAX. DIA. |
| PVC PIPE (SCH. 40) (CELLULAR OR SOLID CORE) | 6" |
| CPVC PIPE (SDR 13.5) | 6" |
| ABS PIPE (SCH. 40) (CELLULAR OR SOLID CORE) | 6" |
| FRPP PIPE (SCH. 40) | 4" |

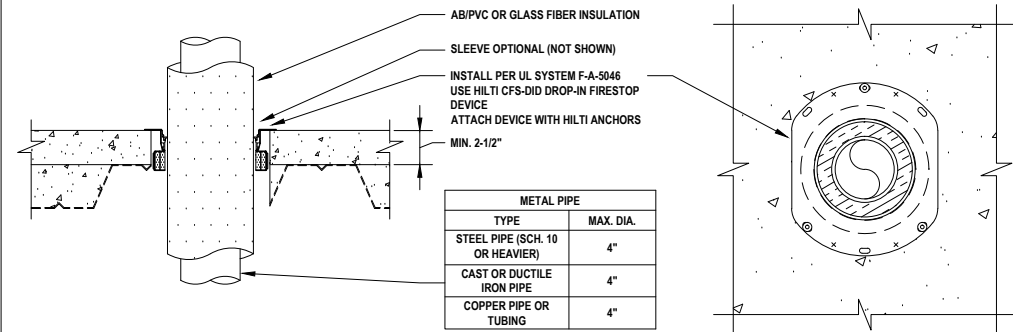

6
M.3.2 METAL PIPE WITH AB/PVC OR GLASS FIBER INSULATION THROUGH CONCRETE OVER METAL DECKING (2-HR.)
NOT TO SCALE

| METAL PIPE | |
|---------------------------------|-----------|
| TYPE | MAX. DIA. |
| STEEL PIPE (SCH. 10 OR HEAVIER) | 4" |
| CAST OR DUCTILE IRON PIPE | 4" |
| COPPER PIPE OR TUBING | 4" |

Notes:

1. Refer to the following specifications for firestopping.
 - a. 07 84 00 Firestopping
 - b. 07 84 13 Penetration Firestopping
 - c. 22 00 00 Plumbing
 - d. 23 00 00 HVAC
 - e. 26 00 00 Electrical
 - f. 27 06 37 Communication

For Quality Control requirements, refer to the Quality Control portion of the specification.

2. Details shown are typical details, containing general information only. Always refer to the full UL system detail for complete system requirements. If field conditions do not match requirements of details, approved alternate details shall be utilized. Design requirements, field conditions and dimensions need to be verified for compliance with the details, including but not limited to the following:

- * Fire Rating (F-Rating)
- * Temperature Rating (T-Rating)
- * Leakage Rating (L-Rating)
- * Water Rating (W-Rating)
- * Annular Space
- * Percent Fill
- * Movement
- * Type and thickness of fire-rated construction.

3. If alternate details matching the field conditions are not available, manufacturer's engineering judgment drawings are acceptable. Contact Hilti Inc. for alternative systems or Engineering Judgment (800-879-8000) Drawings shall follow the International Firestop Council (IFC) Guidelines for Evaluating Firestop Systems Engineering Judgments.

References:

- * 2013 Underwriter's Laboratories Fire Resistance Directory, Volumes 1 & 2
 - * NFPA 101 Life Safety Code
 - * NFPA 70 - National Electric Code
 - * All governing local and regional building codes
5. Firestop System installation must meet requirements of ASTM E-814 (UL 1479) tested assemblies that provide a fire rating equal to that of construction being penetrated.
 6. All rated through-penetration assemblies shall be prominently labeled with a Hilti Firestop Label equipped with a QR code with the following information:
 - * Warning! - Do Not Disturb
 - * Through Penetration Firestop System
 - * UL System # * Product(s) used
 - * Hourly Rating (F-Rating)
 - * Installation Date
 - * Contractor's Name
 7. For outlet boxes requiring protection, use only Wall Opening Protective Materials, category CLIV as classified by Underwriter's Laboratories, Fire Resistance Directory (Volume 1.)

<Notes to designer (delete this note after reading and replace with title block information)>
 1. Any modification to these details could result in an application/system not meeting the UL or Intertek Classification or the intended temperature or fire ratings.
 2. Details shown are up to date as of February 2015.
 3. For additional information on the details, refer to the most current "Underwriter's Laboratories Fire Resistance Directory (volume 2.)"

JOB NUMBER: _____

DRAWN: _____

CHECKED: _____

ISSUE DATE: _____

REVISIONS: _____

CONTENTS: _____

MECHANICAL PENETRATIONS
CONCRETE OVER METAL DECK
2 HR.

SHEET NAME: _____

M.3.2

SHEET NUMBER: _____