

BLANK OPENING IN CONCRETE FLOOR/WALL OR BLOCK WALL

F-RATING = 1-HR.

T-RATING = 1-HR.

CAJ0074c.041316

TOP VIEW

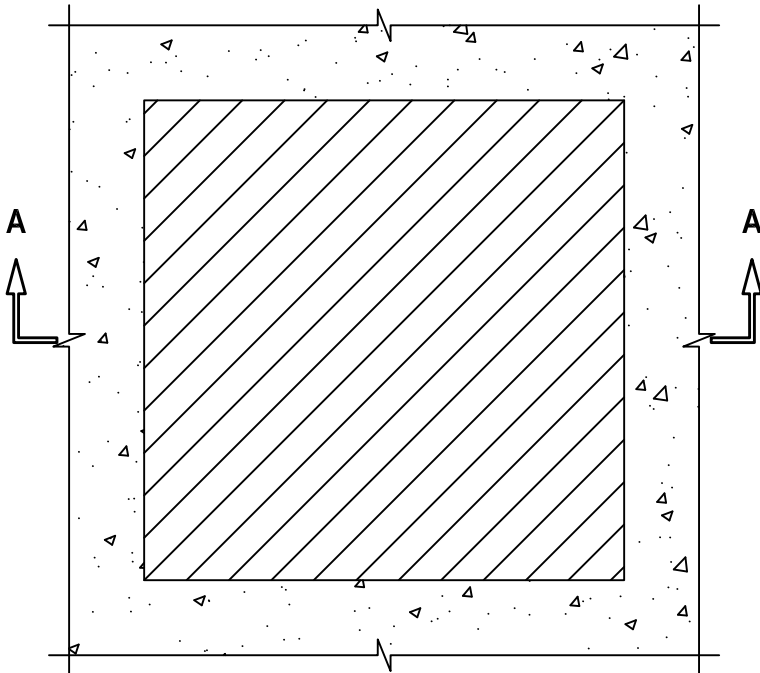

SECTION A-A

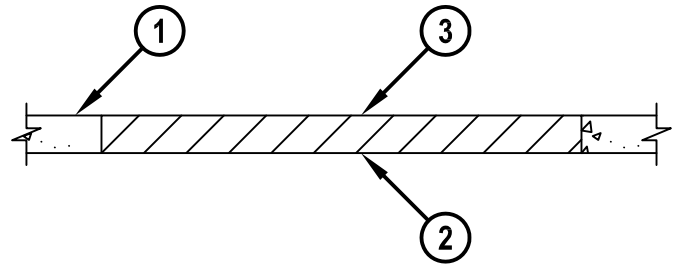

1. CONCRETE FLOOR OR WALL ASSEMBLY (1-HR. FIRE-RATING) :
 - A. LIGHTWEIGHT OR NORMAL WEIGHT CONCRETE FLOOR OR WALL (MIN. 2-1/2" THICK).
 - B. ANY UL/cUL CLASSIFIED CONCRETE BLOCK WALL.
2. FORMING NOT SHOWN. USE A RIGID BOARD MATERIAL TO SUPPORT HILTI CP 637 FIRESTOP MORTAR DURING ITS INITIAL CURE (MIN. 24 HRS.).
3. MINIMUM 2-1/2" DEPTH HILTI CP 637 FIRESTOP MORTAR FLUSH WITH TOP SIDE OF FLOOR OR BOTH SIDES OF WALL.

NOTE : MAXIMUM AREA OF OPENING = 1024 SQ. IN. WITH A MAXIMUM DIMENSION OF 32 IN.



HILTI, Inc.
Plano, Texas USA (800) 879-8000

Sheet	1 of 1
Scale	5/64" = 1"
Date	Apr. 13, 2016

Drawing No.
**CAJ
0074c**